



INSTALLATION MANUAL



BRPP Sump Guard: KTM 390 Adventure

Welcome to the BigRock Performance Parts family!

Thank you for your purchase of the BigRock Performance Parts Sump Guard. You are now a proud owner of a product that comes from our years of rally raid, supercross, motocross, enduro and trail riding experience. It has been designed and developed by BigRock in response to a specific need we felt wasn't met adequately. That's why you will find the same products on our own motorcycles that we use every day. We've put all of our collective motorcycling experience into developing this product so that you can fit it and forget it!

What's in the box?

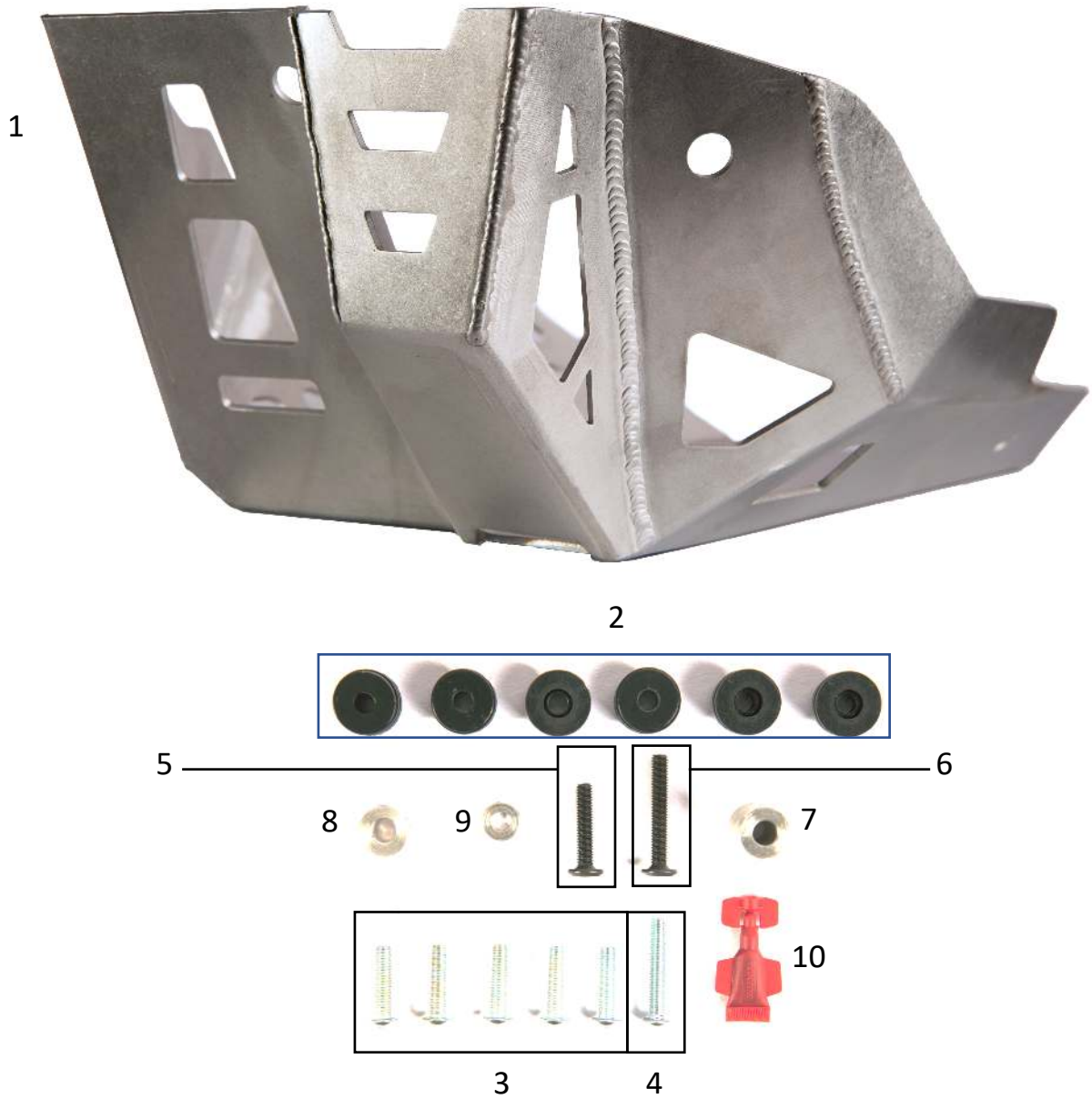

1. Sump guard x1
2. Rubber grommets with metal washers x6
3. Mounting bolt A (29 mm) x5
4. Mounting bolt B (38 mm) x1
5. Mounting bolt C (32 mm) x1
6. Mounting bolt D (42 mm) x1
7. Spacer A (18.5 mm) x1
8. Spacer B (11 mm) x1
9. Spacer C (4 mm) x1
10. Loctite x1

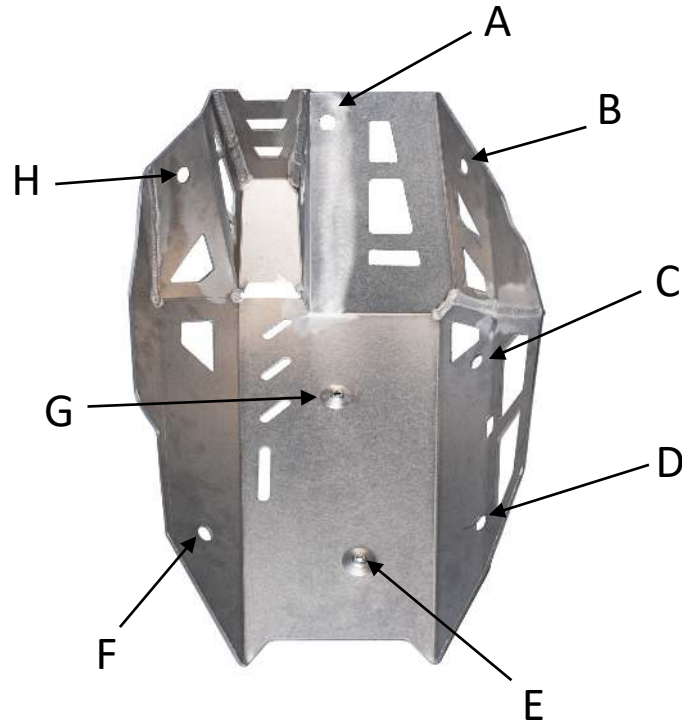

Step 1

Remove stock sump guard. On the BRPP sump guard, insert rubber grommets into mounting points A, B, C, D, F and H.

Step 2

1. Align the sump guard with the stock mounting points.
2. Insert spacer A between the sump guard and mounting point G. Insert mounting bolt D.
3. Insert spacer C between the sump guard and mounting point E. Insert mounting bolt C.
4. Insert spacer B between the sump guard and mounting point B. Insert mounting bolt B.

Use Loctite on all bolts to ensure secure fit.

DO NOT TIGHTEN BOLTS YET.

NOTE: The stock sump guard and mounting bracket has a tendency to deform. The rubber grommets will allow a certain degree of flexibility with regards to misaligned mounting points. If unable to mount, visit your local service centre.

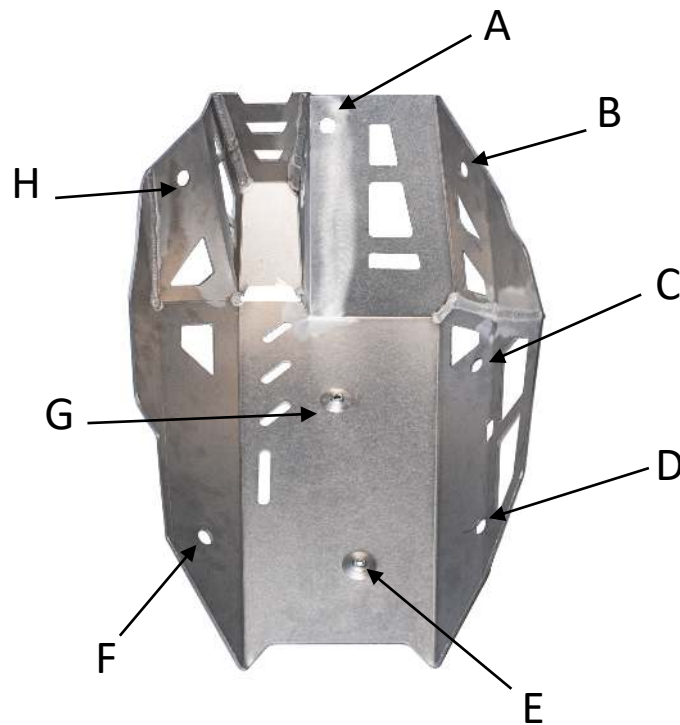

Step 3

Insert remaining mounting bolts into the corresponding mounting points as mentioned below:

Mounting point A - Mounting bolt A

Mounting point C - Mounting bolt A

Mounting point D - Mounting bolt A

Mounting point F - Mounting bolt A

Mounting point H - Mounting bolt A

Use Loctite to ensure a secure fit.

Tighten ALL bolts till completely secure.



Feedback?

Good or bad, we'd love to hear it!
Reach us at performanceparts@bigrockdirtpark.com

THANK YOU!

